

REVISONS		DATE	BY	APP'D
NO.	DESCRIPTION			
A	FIRST VERSION	17/02/04	GF	SM
B	ADD NEW PART No.	27/04/05	GF	SM

NOTES :

△ MATERIALS AND FINISH:

— HOUSING: PA66  
 — CONTACTS: COPPER ALLOY, FINISH: TIN OVER NICKEL UNDERPLATE

2. MUST COMPLY WITH DIRECTIVE 2002/95/EC (ROHS)

3. WIRE TYPES AND SIZES ACCEPTED

WIRE RANGE: 20AWG~26AWG(SOLID&STRANDED)  
 STRIP LENGTH: 7.5mm~8.5mm

4. PACKAGED IN TRAY.

5. CURRENT RATING: 5Amp AC300V.

6. OPERATION TEMPERATURE: -40°C TO +105°C

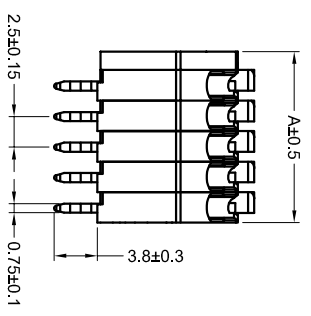
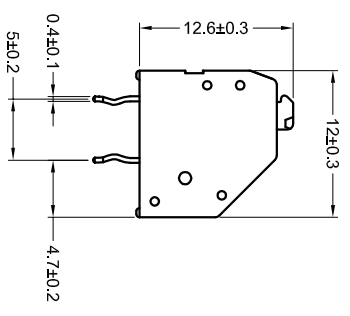
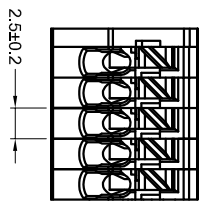
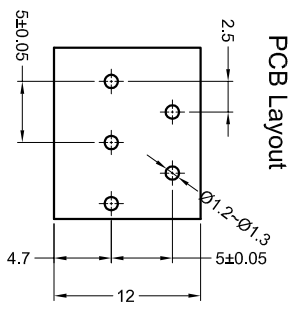

COLOR CODE: \_\_\_\_\_

PIN No: \_\_\_\_\_

P/N: \*-2834021-\*

SERIES CODE	2=2 POSN
1=GREEN	3=3 POSN
2=BLUE	4=4 POSN
3=BROWN	5=5 POSN
4=ORANGE	6=6 POSN
5=GREY	7=7 POSN
6=RED	8=8 POSN
7=YELLOW	
8=PURPLE	
9=WHITE	
0=BLACK	

REMARK: THE DIFFERENT COLORS COULD BE COMBINED TO THE NEW CONNECTOR P/Ns FOR CUSTOMER REQUEST.

21.50	8 POSN		
19.00	7 POSN		
16.50	6 POSN		
14.00	5 POSN		
11.50	4 POSN		
9.00	3 POSN		
6.50	2 POSN		
A	NO. OF POSITIONS		

THIS DRAWING IS A CONTROLLED DOCUMENT.

DESIGNER	CHKD	DATE
SHI MING	SHI MING	27/04/05

2.50mm Pitch Modular Screwless Conn.

STC TE Connectivity

SIZE 1 CODE 00779 -2834021

SCALE 1:1 SHEET 1 OF 1 REV B