

© 1960 BY AMP INCORPORATED. ALL RIGHTS RESERVED. AMP PRODUCTS COVERED BY PATENTS AND/OR PATENTS PENDING. APPROVED PER GOVT CONTRACT NO.

NUMBER 42107

REVISIONS

SYM	ZONE	DESCRIPTION	DATE	APPROVAL
E		REVISED & REDRAWN	7-981	8-8-63
F		OBSOLETE 42107-1 & 42279-4	2102 DR	5-11-69
G		PRINT DIST WAS "39" LOC WAS "AB"	3347	10-72
H		REVISED WORDING IN TABLE & NAME	468	1-13-77
J		.0001 BRIGHT TIN WAS .0002 TIN ON 42107-2	EA 1049	1-3-79
K		REVISED PLATING	EA 1515	8-1-80
L		BRIGHT TIN-LEAD WAS BRIGHT TIN	EA 1818	6-16-81
M		REVISED GOLD PLATING	EA 2139	6-16-82
N		.176 WAS .175, REVISED PICTURE	ECN S3056	4-29-85
P		OBS 42279-3	ECN S3379	11-24-86
R		OBS 42107-4	ECN S3733	4-14-87
R		OBS 42279-2	ECN S3940	4-28-87
S		REVISED PER OH14-0139-05		1-25-06

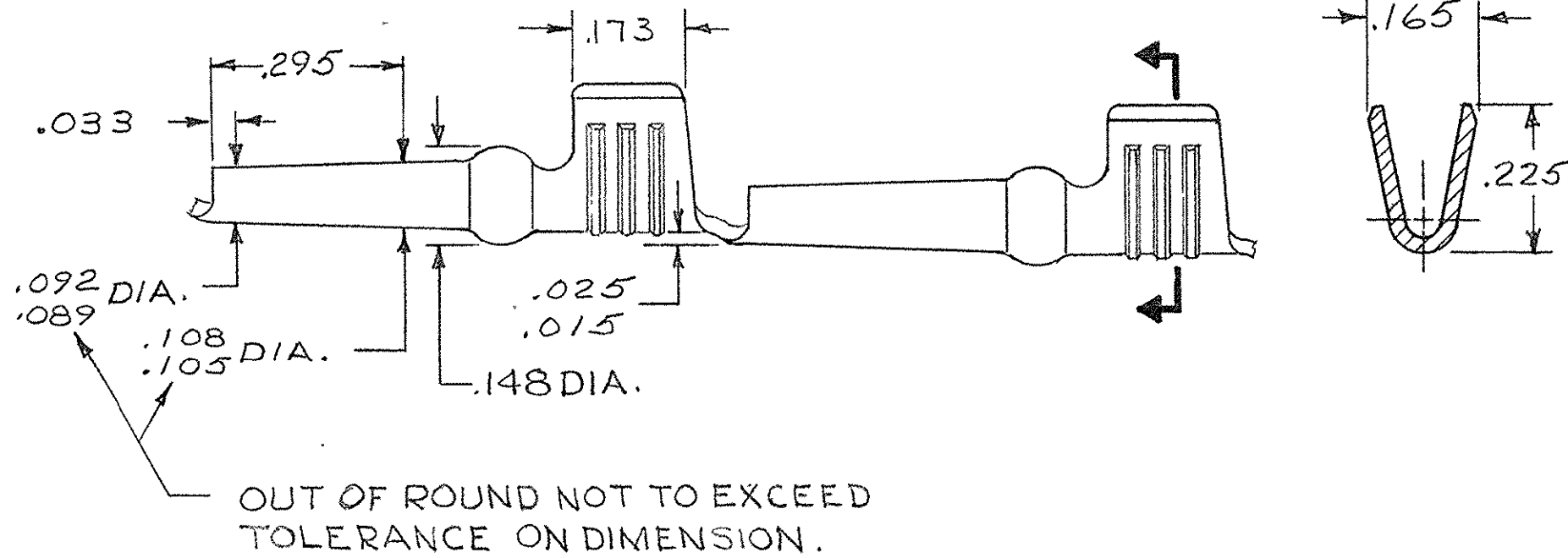
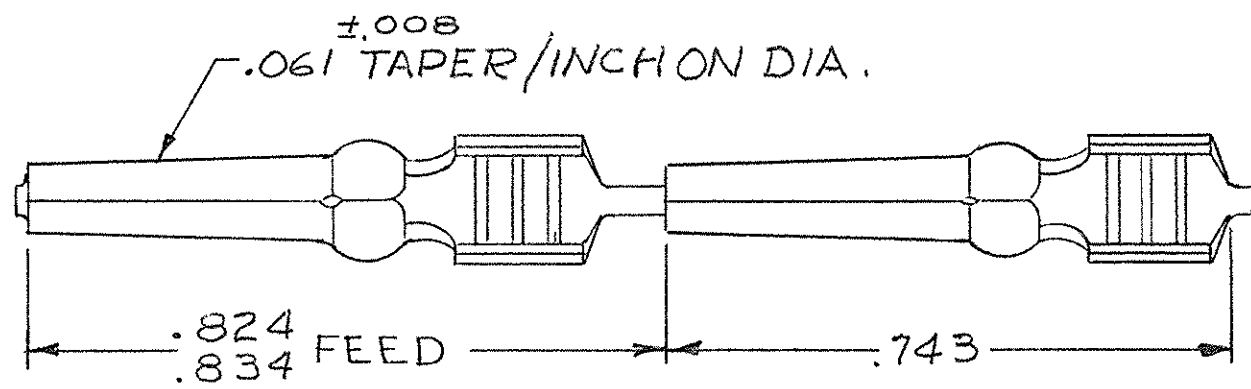

STRIP

⚠ OBSOLETE PART NO.

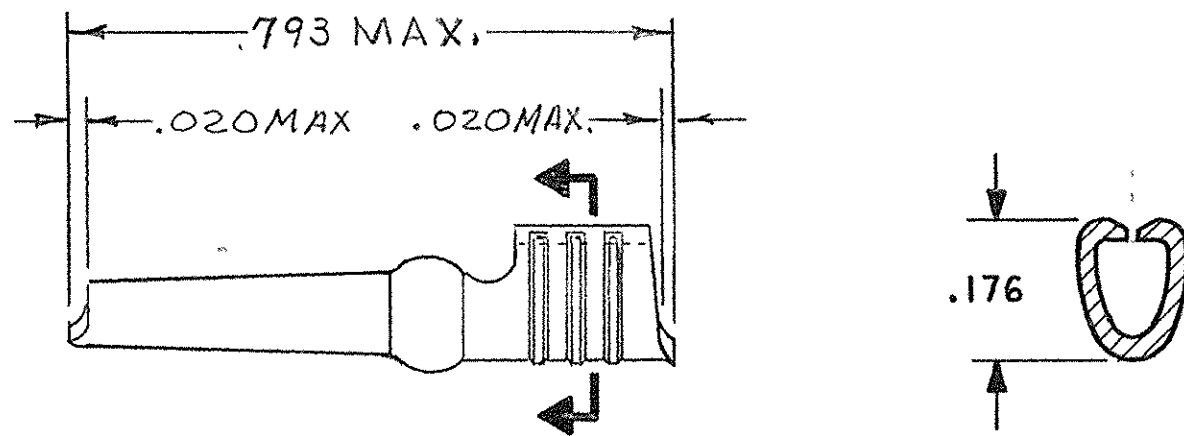

LOOSE PIECE

5-42107-2	5-42279-1	12-14	.0000 MATTE TIN	380306-8	47689	#12-113 #14-102
OBSOLETE 42107-1	42279-4	12-14	PLAIN	380306-8	47689	#12-113 #14-102
OBSOLETE 42107-4	42279-3	12-14	.00003 GOLD OVER .00005 NICKEL	380306-8	47689	#12-113 #14-102
42107-3	42279-2	12-14	.0002 SILVER	380306-8	47689	#12-113 #14-102
42107-2	42279-1	12-14	.0001 BRIGHT TIN-LEAD	380306-8	47689	#12-113 #14-102
STRIP PART NO.	LOOSE PIECE PART NO.	WIRE SIZE	FINISH	INSERT TOOL	HAND TOOL	CRIMP HEIGHT

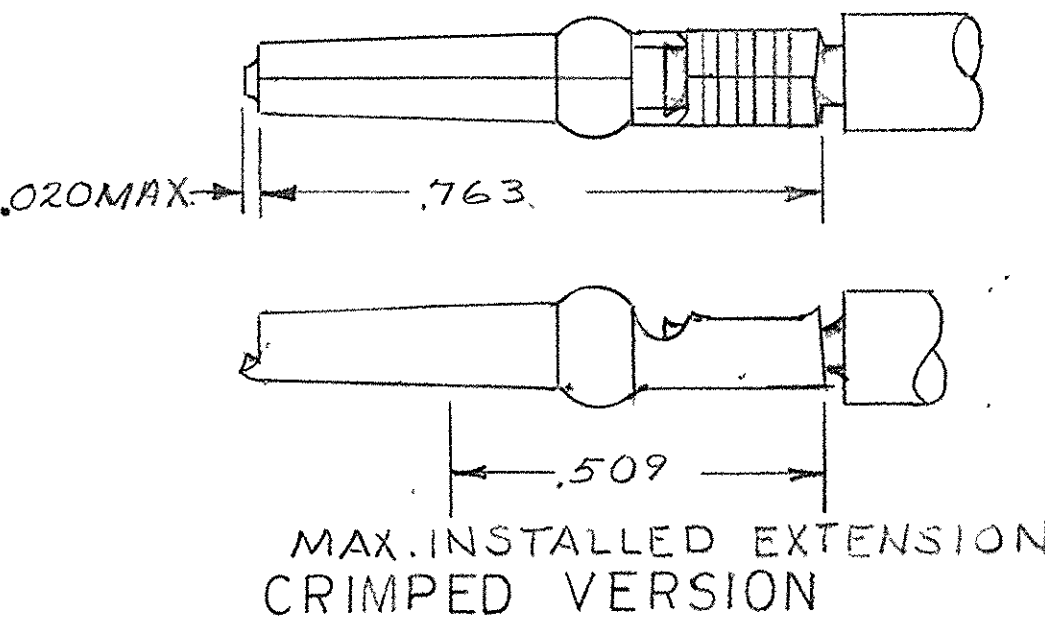

MAX. INSTALLED EXTENSION CRIMPED VERSION

M 3	INFO	QTY REQD	NOMENCLATURE OR DESCRIPTION	PART OR IDENTIFYING NO		
S	12					
LIST OF MATERIALS OR PARTS LIST						
UNLESS OTHERWISE SPECIFIED DIMENSIONS ARE IN INCHES TOLERANCES ON			SIGNATURE		DATE	
FRACTIONS ± .010			DR <i>J. Kaufman</i>		8-12-63	
DECIMALS ± .010			CHK <i>J. Kaufman</i>		8-18-63	
ANGLES ± .5			DSGN ENGR <i>R.G. Hollett</i>		5-14-63	
MATERIAL .025 COML. BRASS			APPD <i>[Signature]</i>		4/14/63	
HEAT TREAT			DSGN APPD		CODE IDENT NO	
FINISH SEE TABLE			OTHER APPD		00779	
					SIZE C	
					NUMBER 42107	
					SCALE 4-1	
					WT CALC ACTUAL	
					SHEET 1 OF 1	

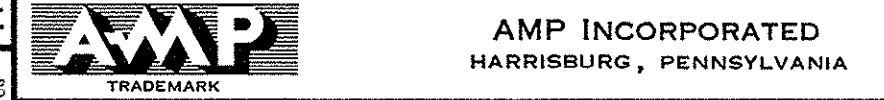

PIN, TAPER, 88 SERIES, NON-INSULATION SUPPORT