

## K41 Series Make & Break Load Switching — 5.0 kV Relays

### K41A, K41B Product Facts

- High current carry rating
- Vacuum dielectric for power switching low current loads
- Glazed ceramics for low current leakage
- Compact, space-saving design
- Meets requirements of MIL-R-83725
- QPL versions available, M83725/21 & M83725/22

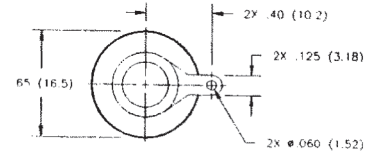
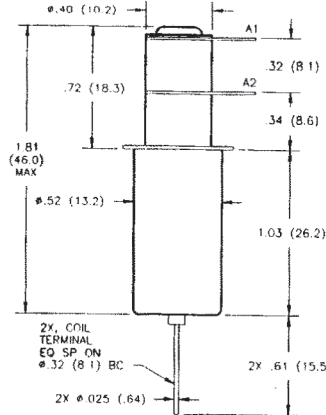
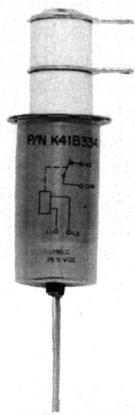

### K41C Product Facts

- Single pole, double throw version
- Vacuum dielectric for power switching low current loads
- RF ratings to 32 MHz
- Long life: 2 million cycles
- Meets requirements of MIL-R-83725
- QPL version available, M83725/23

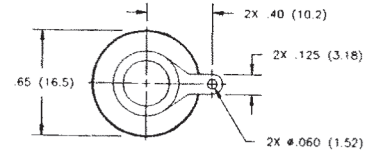
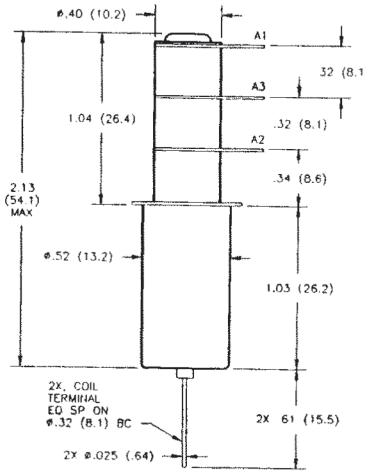
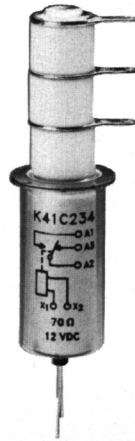

### Product Specifications for K41A, K41B and K41C

#### Contact Arrangement —

K41A — SPST-NO  
K41B — SPST-NC  
K41C — SPDT

#### Contact Form —

K41A — A  
K41B — B  
K41C — C

**Test Voltage, DC or 60 Hz (Peak)** — 6 kV

#### Rated Operating Voltage (Peak) —

DC or 60 Hz — 5 kV  
2.5 MHz — 4.5 kV  
16 MHz — 3.5 kV  
32 MHz — 2.8 kV

#### Continuous Carry Current, Max. —

DC or 60 Hz — 30 A  
2.5 MHz — 24 A  
16 MHz — 16 A  
32 MHz — 12 A  
Coil Hi-Pot (Vrms, 60 Hz) — 500 A

#### Contact Capacitance —

Between Open Contacts — 1.2 pF  
Open Contacts to Ground — 1.2 pF

#### Contact Resistance, Max. —

0.02 ohm

#### Operate Time, Max. —

10 ms

#### Release Time, Max. —

10 ms

#### Shock, 11ms, 1/2 Sine (Peak) —

50 g

#### Vibration —

Peak — 10 g (55 to 2000 Hz)

#### Operating Ambient Temperature Range —

-55°C to +125°C

#### Mechanical Life —

2 million cycles

#### Weight, Nominal —

28.35 g (1.0 oz.)

### Coil Data

Nominal Volts DC	12 Vdc	26.5 Vdc	115 Vdc
Pickup, Max.	8 Vdc	16 Vdc	80 Vdc
Dropout	.5-5 Vdc	1-10 Vdc	5-50 Vdc
Coil Resistance ( $\pm 10\%$ )	70 $\Omega$	290 $\Omega$	4700 $\Omega$

Ratings listed are for 25°C, sea level conditions

### Ordering Information

#### Sample Part Number ▶

**K41 A 3 3 4**

#### Series: \_\_\_\_\_

#### Contact Form: \_\_\_\_\_

A = SPST-NO    B = SPST-NC    C = SPDT

#### Coil Voltage: \_\_\_\_\_

2 = 12 Vdc, Bus Wire    3 = 26.5 Vdc, Bus Wire  
5 = 115 Vdc, Bus Wire    7 = 12 Vdc, Turret Terminal\*  
8 = 26.5 Vdc, Turret Terminal\*  
9 = 115 Vdc, Turret Terminal\*

#### High Voltage Connections: \_\_\_\_\_

3 = Solder Connection

#### Mounting: \_\_\_\_\_

2 = Flanged

4 = Standard

For factory-direct application assistance, dial 800-253-4560, ext. 2055, or 805-220-2055.

**\*See page 7-87 for turret terminal dimensions and mounting methods.**

**K41 Series Make & Break Load Switching — 5.0 kV Relays**

**K41P**

**Product Facts**

- Fast, 6 millisecond operate time
- Vacuum dielectric for power switching low current loads
- Latching actuator for low power consumption
- Ideal for frequency agile communication systems
- Meets requirements of MIL-R-83725
- QPL version available, M83725/24

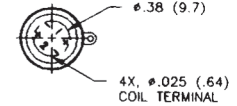
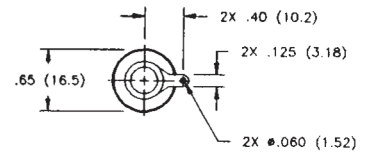
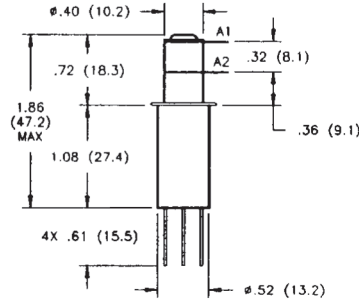
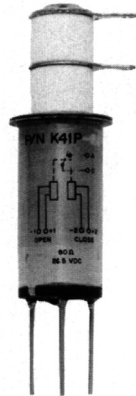

**K41R**

**Product Facts**

- Latching actuator for low power consumption
- Vacuum dielectric for power switching low current loads
- Meets requirements of MIL-R-83725
- Latching version of K41C

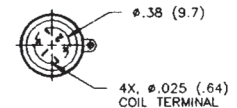
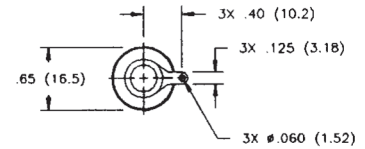
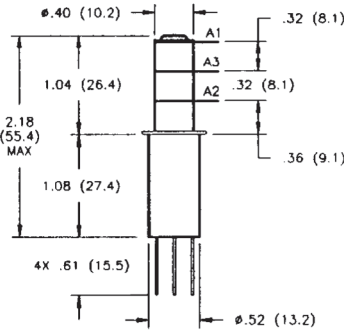
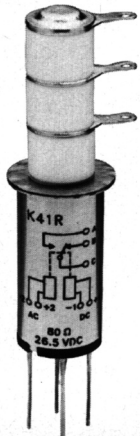

**Product Specifications for K41P and K41R**

**Contact Arrangement** —  
 K41P — SPST-Latching  
 K41R — SPDT-Latching

**Contact Form** —  
 K41P — P  
 K41R — R

**Test Voltage, DC or 60 Hz (Peak)** —  
 6 kV

**Rated Operating Voltage (Peak)** —  
 DC or 60 Hz — 5 kV  
 2.5 MHz — K41P — 4.5 kV  
                   K41R — 4.0 kV  
 16 MHz — K41P — 3.5 kV  
                   K41R — 3.2 kV  
 32 MHz — K41P — 2.8 kV  
                   K41R — 2.5 kV

**Continuous Carry Current, Max.** —  
 DC or 60 Hz — 30 A  
 2.5 MHz — K41P — 20 A  
                   K41R — 16 A  
 16 MHz — K41P — 13 A  
                   K41R — 10 A  
 32 MHz — K41P — 10 A  
                   K41R — 6 A  
 Coil Hi-Pot (Vrms, 60 Hz) — 500 A

**Contact Capacitance** —  
 Between Open Contacts —  
 K41P — 1.2 pF  
 K41R — 1.6 pF  
 Open Contacts to Ground —  
 K41P — 1.2 pF  
 K41R — 1.6 pF

**Contact Resistance, Max.** —  
 0.02 ohm

**Operate Time, Max.** — 6 ms

**Release Time, Max.** — N/A

**Shock, 11ms, 1/2 Sine (Peak)** —  
 K41P — 50 g  
 K41R — 30 g

**Vibration** —  
 Peak — 10 g (55 to 2000 Hz)

**Operating Ambient Temperature Range** — -55°C to +125°C

**Insulation Resistance** —  
 Initial — 10 gigaohms

**Mechanical Life** — 1 million cycles

**Weight, Nominal** —  
 28.35 g (1.0 oz.)

**Coil Data**

Volts, Nominal	26.5 Vdc
Reset & Latch, Max.	16 Vdc
Dropout	N/A
Coil Resistance (±10%)	80 Ω

Ratings listed are for 25°C, sea level conditions.

**Ordering Information**

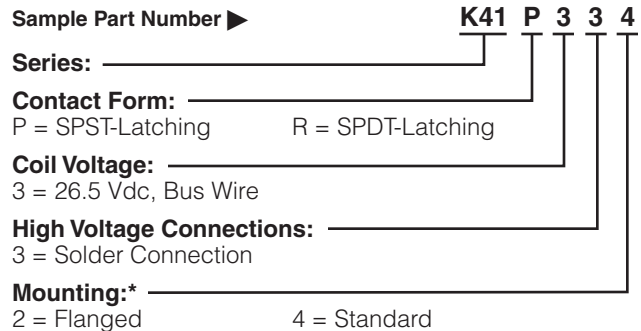

\*See page 7-87 for mounting methods.

For factory-direct application assistance, dial 800-253-4560, ext. 2055, or 805-220-2055.