

THIS DRAWING IS UNPUBLISHED. RELEASED FOR PUBLICATION
 © COPYRIGHT - By - ALL RIGHTS RESERVED.

| LOC | DIST | REVISIONS | | | | | |
|-----|------|-----------|-----|----------------------|----------|-----|------|
| CM | 53 | P | LTR | DESCRIPTION | DATE | DWN | APVD |
| | | P1 | | REV PER ECO 12-13810 | 13SEPT12 | JR | TM |

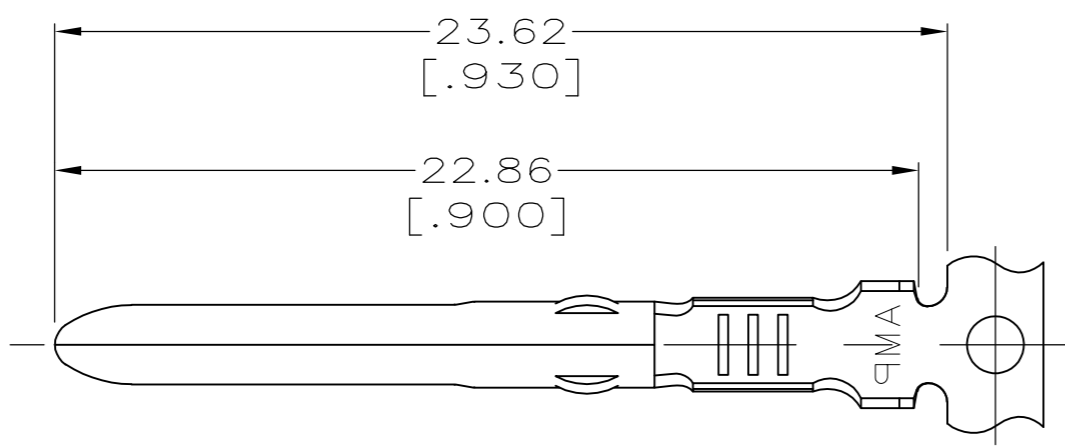

1. REFER TO AMP SPEC 108-1015 FOR TERMINATION REQUIREMENTS.
2. WIRE RANGE: 0.2 - 0.9 mm² [24 - 18 AWG].
3. INSULATION RANGE: 2.54 [.100] MAX DIA.
4. DIMENSIONS IN BRACKETS ARE IN INCHES.

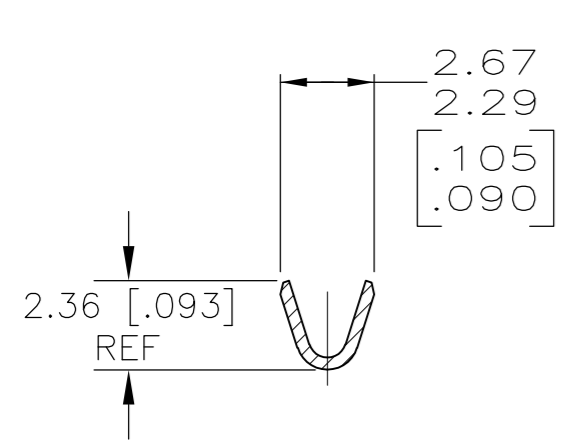
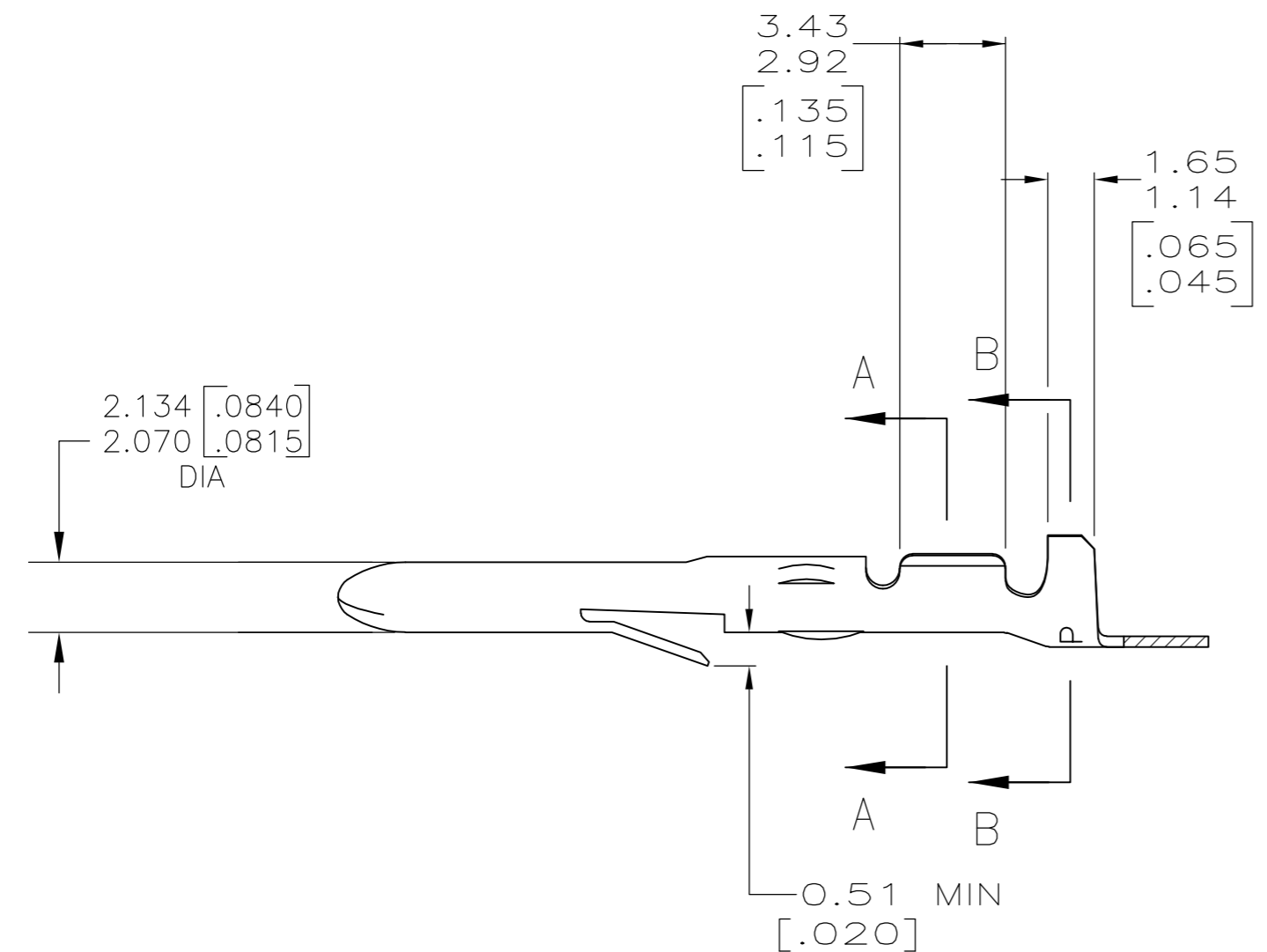

SECTION A-A

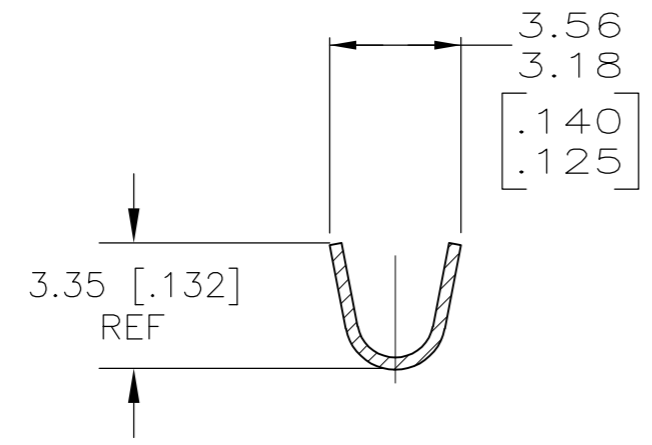

SECTION B-B

| | | |
|---------|-------------------|---------|
| PRE-TIN | 0.30 [.012] BRASS | 61527-2 |
| FINISH | MATERIAL | PART NO |

| | | | | | |
|---|-----------|--------|-----------|---------------------|-----------------|
| THIS DRAWING IS A CONTROLLED DOCUMENT. | | DWN | 1-28-93 | TE Connectivity | |
| DIMENSIONS: mm [INCHES] | | CHK | 1-28-93 | | |
| TOLERANCES UNLESS OTHERWISE SPECIFIED: | | APVD | 2-10-93 | | |
| 0 PLC ± - 1 PLC ± - 2 PLC ± 0.25 [.010] 3 PLC ± - 4 PLC ± - ANGLES ± - | | NAME | C. MARTIN | | |
| MATERIAL | SEE TABLE | FINISH | SEE TABLE | PRODUCT SPEC | PIN, MATE-N-LOK |
| CUSTOMER DRAWING | | WEIGHT | - | APPLICATION SPEC | - |
| SCALE | | 5:1 | SHEET | 1 of 1 | RESTRICTED TO |
| REV | | P1 | | | |