

REVISIONS			
LTR	DESCRIPTION	DATE	APPROVED
N/C	INITIAL RELEASE PER ECN# T-17740	92 SEPT 8	Z. TEMAN
A	REVISED PER ECN# T-18523		

NOTES:

- MATERIAL: LNP STATKON-FE (VIRGIN) HIGH DENSITY POLYETHYLENE.
COLOR: BLACK
- RESISTIVITY OF MATERIAL ELECTRICALLY CONDUCTIVE PER MIL-STD-1686

③ VIEW SHOWING TYPICAL INSTALLATION (ROTATED 180°).

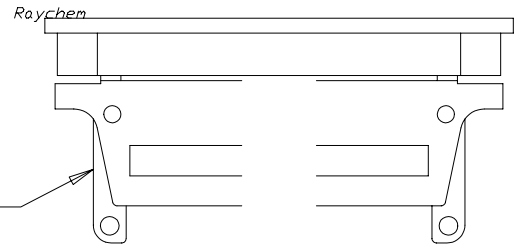
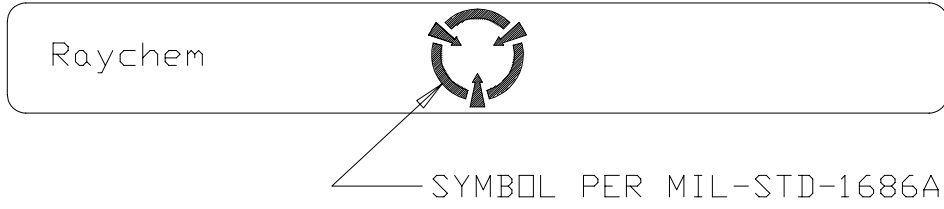
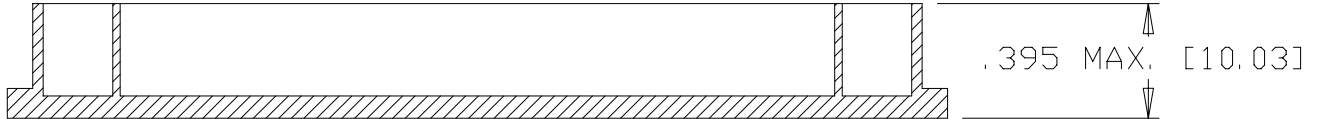
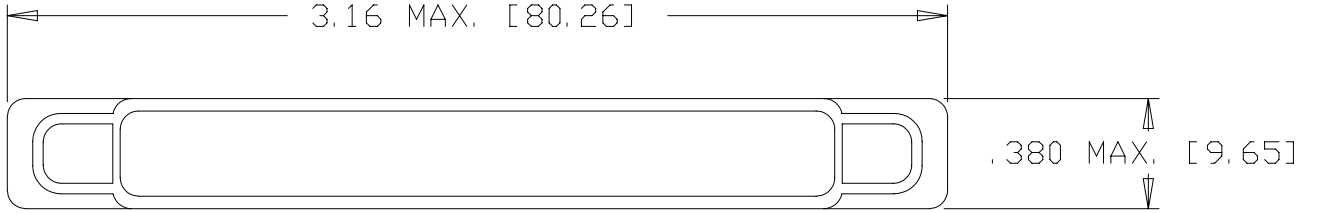

If this document is printed it becomes uncontrolled.
Check with the web for latest revision.

SPECIFICATION CONTROL DRAWING © Raychem Corporation 1992

UNLESS OTHERWISE SPECIFIED
DIMENSIONS ARE IN INCHES.
METRIC DIMENSIONS ARE
IN BRACKETS.

DECIMALS
.XXX ± — [— mm]
.XX ± — [— mm]

ANGLES
.X ± —

WEIGHT
2.37 g MAX.

DRAWN	J. B. K.	92 AUG 10
CHECKED		
APPROVED		
APPROVED	Z. TEMAN	92 SEPT 8
CAD NAME	009233-1	
THIRD ANGLE PROJECTION		

RAYCHEM CORPORATION 300 CONSTITUTION DRIVE MENLO PARK, CALIFORNIA 94025			
TITLE CAP, DUST, PLUG, 2 INCH, CONDUCTIVE, MTC SERIES			
PCN: 707379			
SIZE	CODE IDENT. NO.	DWG. NO.	REV
A	06090	CHA-0269	A
DO NOT SCALE THIS DRAWING			SHEET 1 OF 1