

SPRING-LOADED PINS

DISCRETE SPRING-LOADED CONTACTS

0965

0965-0-15-20-80-14-11-0

Ultra low profile, Surface mount

* Stainless steel spring

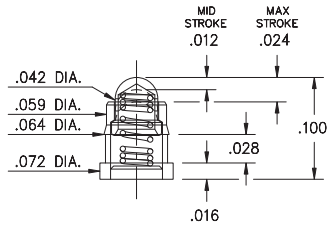

0921-0

0921-0-15-20-76-14-11-0

Ultra low profile, Short stroke. Solder mount in .070 min. mount. hole

Also available on 24mm wide carrier tape; 1,700 parts per 13" reel

Order as: 0921-0-57-20-76-14-11-0

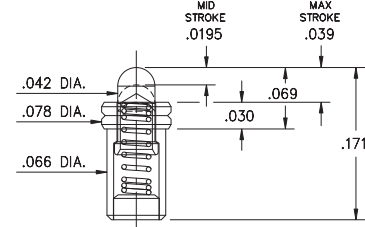

0921-1

0921-1-15-20-7X-14-11-0

Low profile, Standard stroke. Solder mount in .070 min. mount. hole

Also available on 24mm wide carrier tape; 1,500 parts per 13" reel

Order as: 0921-1-57-20-75-14-11-0

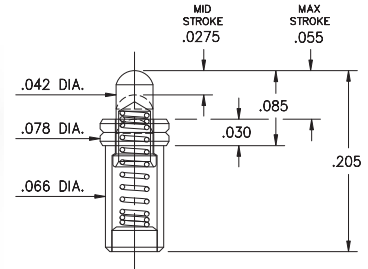

0926-0

0926-0-15-20-76-14-11-0

Low Profile, Short Stroke

Solder mount in .074 min. mounting hole

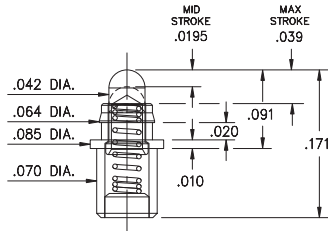

0926-1

0926-1-15-20-75-14-11-0

Low profile, Standard stroke

Solder mount in .074 min. mounting hole

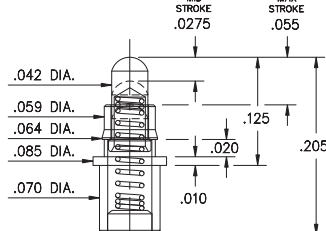

0977

0977-0-15-20-7X-14-11-0

Standard stroke, Surface mount

Also available on 24mm wide carrier tape; 1,100 parts per 13" reel

Order as: 0977-0-57-20-7X-14-11-0

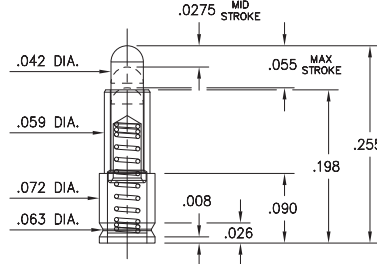

0911

0911-0-15-20-86-14-11-0

Standard stroke, Surface mount

* Stainless steel spring

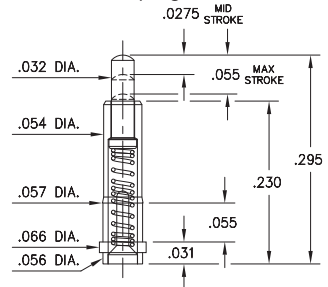

0980

0980-0-15-20-7X-14-11-0

Double action, .055 Combined stroke

Mount between parallel circuit boards

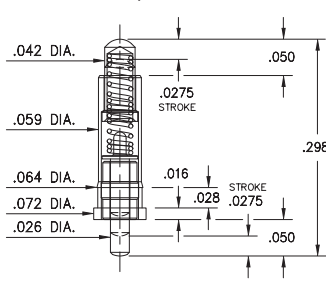

0959

0959-0-54-20-7X-14-11-0

Receptacle spring pin, Standard stroke

Accepts .020" - .032" Dia. pins

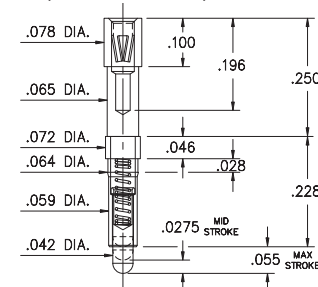

0919

0919-0-15-20-89-14-11-0

3mm (.118") Long stroke, Surface mount

* Stainless steel spring

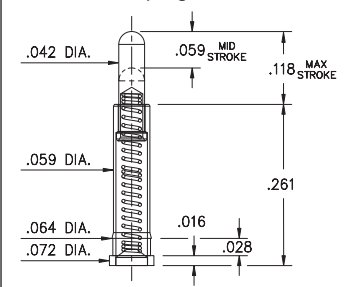

Material Specifications:

Sleeve & Plunger Material: Copper Alloy

Spring Material: BeCu or Stainless Steel 302 *

Sleeve & Plunger Finish: 20 μ" Gold over Nickel

Spring Finish: 10 μ" Gold over Nickel

Dimensions: Inches

Tolerances On: Lengths: ± .006

Diameters: ± .002

Angles: ± 2°



Mechanical & Electrical Specifications:

Durability: Up to 1,000,000 cycles

Current Rating: 2A continuous, 3A peak

Contact Resistance: 20 mΩ max.

Environmental Specifications:

Operating temperature range:

-55/+125° C (discontinuous)

75, 76, 80, 85, 86, 89 Springs are not interchangeable

Order Code: 09XX - X - 15 - 20 - XX - 14 - 11 - 0

Spring Number

Spring Number	Mid. Stroke	Max. Stroke	Force @ Mid. Stroke	Initial Force (Pre-Load)
75	.0275	.055	60 g	25 g
76	.0195	.039	60 g	25 g
80	.012	.024	70 g	25 g
85	.040	.080	60 g	25 g
86	.0275	.055	60 g	25 g
89	.059	.118	85 g	25 g

