

INTERCONNECTS

SERIES 329, 340, 406, 414, 429 • .100" GRID SURFACE MOUNT HEADERS AND SOCKETS • SINGLE AND DOUBLE ROW STRIPS

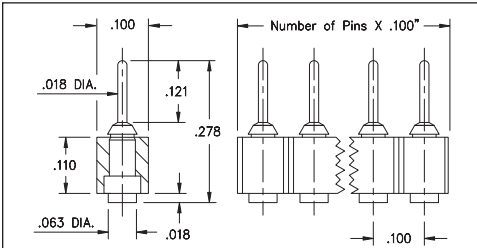

FIG. 1

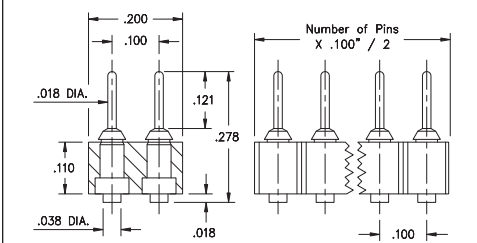

FIG. 2

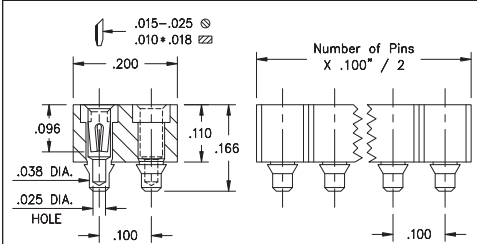
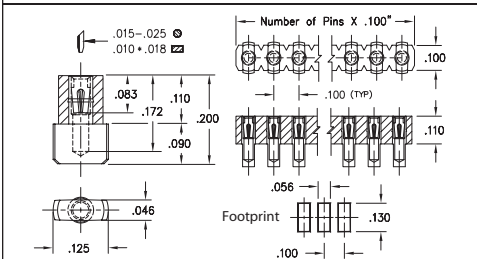

FIG. 3



Coplanarity .005". For pin counts >24 positions, consult Technical Support.

FIG. 4

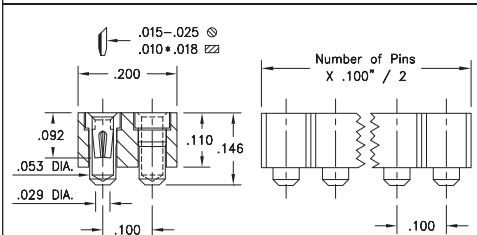
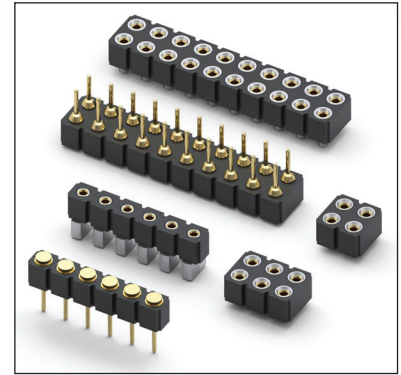

FIG. 5

- Series 329 and 429 pin interconnects feature space saving, pad style SMT termination using MM #2956-X pins. See page 218 for details
- Series 429 and 414 combine for a mated height of .323"
- Series 340, 406 and 414 surface mount sockets use MM #4078, #0668 and #1434 receptacles. See pages 162, 164 and 167 for details
- Series 340, 406 and 414 receptacles use Hi-Rel, 4-finger BeCu #30 contacts rated at 3 amps. Receptacles accept .015"-.025" diameter pins. See page 253 for details
- Insulators are high temperature thermoplastic, suitable for all soldering operations



ORDERING INFORMATION

FIG. 1	Series 329...560 Single Row Surface Mount Pin Header
	329-10-1__-00-560000 Specify number of pins ↑ 02-64
FIG. 2	Series 429...560 Double Row Surface Mount Pin Header
	429-10-2__-00-560000 Specify number of pins ↑ 04-72
SPECIFY PLATING CODE XX= 10 ◆	
Pin Plating	10 μ" Au
FIG. 3	Series 414...117 Double Row Surface Mount Socket
	414-XX-2__-41-117000 Specify number of pins ↑ 04-72
FIG. 4	Series 340...780 Single Row Surface Mount Socket
	340-XX-1__-30-780100 Specify number of pins ↑ 02-64
FIG. 5	Series 406...068 Double Row Surface Mount Socket
	406-43-2__-30-068000 Specify number of pins ↑ 04-20
	Tape and Reel Packaging
Ordering Information: 406-43-2XX-30-068001	
Available on 44mm wide tape, 355 parts per 13" reel ←	
<div style="display: flex; justify-content: space-around; align-items: center;"> <div style="border: 1px solid black; padding: 5px; text-align: center;"> RoHS-2 2011/65/EU </div> <div style="border: 1px solid black; border-radius: 50%; padding: 5px; text-align: center;"> XX=Plating Code See Below </div> <div style="border: 1px solid black; border-radius: 50%; padding: 5px; text-align: center;"> For Electrical, Mechanical & Environmental Data, See page 264 </div> </div>	
SPECIFY PLATING CODE XX= 99 41 ◆ 43 ◆ 44 ◆	
Sleeve (Pin)	200 μ" Sn/Pb 200 μ" Sn 200 μ" Sn 200 μ" Sn
Contact (Clip)	100 μ" Sn/Pb 10 μ" Au 30 μ" Au 100 μ" Sn