

THIS DRAWING IS UNPUBLISHED. RELEASED FOR PUBLICATION
 © COPYRIGHT - By - ALL RIGHTS RESERVED.

REVISIONS					
P	LTR	DESCRIPTION	DATE	DWN	APVD
	M	REVISED PER ECO-17-013721	16NOV2017	RS	MZ
	N	REVISED PER ECO-18-005775	24APR2018	RS	MZ

D

[.012][.28] A 12 6.1 [.241] 3-2 28 0.10 [.004] 06045 5-192047-0 OBSOLETE ¹⁸									
[.012][.26] A 12 5.7 [.226] 3-2 26 0.10 [.004] 06017 4-192047-9 OBSOLETE									
[.012][.25] A 12 5.3 [.210] 3-2 24 0.10 [.004] 06044 4-192047-8 OBSOLETE ¹⁸									
[.012][.23] A 12 4.8 [.188] 3-2 22 0.10 [.004] 06052 4-192047-7 OBSOLETE ¹⁸									
[.012][.22] A 12 4.7 [.187] UNPL 21 0.10 [.004] 06021 4-192047-6 OBSOLETE ¹⁸									
[.012][.22] A 12 4.5 [.179] 3-2 21 0.10 [.004] 06043 4-192047-5 OBSOLETE ¹⁸									
[.012][.20] A 12 4.3 [.168] 3-2 19 0.10 [.004] 06016 4-192047-4 OBSOLETE									
[.012][.19] A 12 4.1 [.160] 6-2 18 0.10 [.004] 06065 4-192047-3 OBSOLETE ¹⁸									
[.012][.19] A 12 4.1 [.160] UNPL 18 0.10 [.004] 06066 4-192047-2 OBSOLETE ¹⁸									
[.012][.17] A 12 3.7 [.146] UNPL 16 0.12 [.005] 06011 4-192047-1 OBSOLETE ¹⁸									
[.012][.17] A 12 3.7 [.146] 4-2 16 0.10 [.004] 06035 4-192047-0 OBSOLETE									
[.012][.17] A 12 3.7 [.146] UNPL 16 0.10 [.004] 06010 3-192047-9 OBSOLETE ¹⁸									
[.012][.17] A 12 3.7 [.146] UNPL 16 0.08 [.003] 06009 3-192047-8 OBSOLETE ¹⁸									
[.012][.15] A 12 3.2 [.125] 6-2 14 0.10 [.004] 06064 3-192047-7									
[.012][.15] A 12 3.2 [.125] 5 14 0.10 [.004] 06056 3-192047-6									
[.012][.15] A 12 3.2 [.125] UNPL 14 0.10 [.004] 06055 3-192047-5 OBSOLETE ¹⁸									
[.012][.15] A 12 2.9 [.113] 3-2 14 0.10 [.004] 06042 3-192047-4 OBSOLETE ¹⁸									
SUPERSEDED BY 3-192047-5									
[.012][.15] A 12 2.9 [.113] UNPL 14 0.08 [.003] 06022 3-192047-2 OBSOLETE ¹⁸									
[.012][.11] A 12 2.0 [.080] 3-2 10 0.15 [.006] 06076 3-192047-1 OBSOLETE									
[.012][.11] A 12 2.0 [.080] UNPL 10 0.15 [.006] 06075 3-192047-0 OBSOLETE									
[.012][.11] A 12 2.0 [.080] 4-2 10 0.12 [.005] 06074 2-192047-9									
[.012][.11] A 12 2.0 [.080] UNPL 10 0.12 [.005] 06073 2-192047-8									
[.012][.11] A 12 2.0 [.080] 3-2 10 0.10 [.004] 06070 2-192047-7									
[.012][.11] A 12 2.0 [.080] UNPL 10 0.10 [.004] 06041 2-192047-6 OBSOLETE									
[.012][.11] A 12 2.0 [.080] C 9 0.10 [.004] 06037 2-192047-5									
[.012][.11] A 12 2.0 [.080] UNPL 9 0.10 [.004] 06047 2-192047-4									
[.012][.09] A 12 1.6 [.062] 3-2 8 0.10 [.004] 06069 2-192047-3									
[.012][.09] A 12 1.6 [.062] UNPL 8 0.10 [.004] 06008 2-192047-2									
SUPERSEDED BY 193810-2									
SUPERSEDED BY 193810-1									
[.014][.09] A 12 1.6 [.062] 6-2 7 0.10 [.004] 06063 1-192047-9									
[.014][.09] A 12 1.6 [.062] 3-2 7 0.10 [.004] 06068 1-192047-8 OBSOLETE ¹⁸									
[.014][.09] A 12 1.6 [.062] UNPL 7 0.10 [.004] 06067 1-192047-7 OBSOLETE ¹⁸									
SUPERSEDED BY 1-192047-7									
[.012][.09] A 12 1.6 [.062] UNPL 8 0.08 [.003] 06007 1-192047-5 OBSOLETE ¹⁸									
[.012][.06] A 12 1.0 [.040] 3-2 6 0.10 [.004] 06014 1-192047-4									
[.012][.06] A 12 1.0 [.040] UNPL 6 0.10 [.004] 06026 1-192047-3 OBSOLETE ¹⁸									
[.012][.06] A 12 0.6 [.025] 3-2 4 0.10 [.004] 06013 1-192047-2 OBSOLETE									
[.012][.06] A 12 0.6 [.025] UNPL 4 0.10 [.004] 06025 1-192047-1 OBSOLETE									
[.013][.06] A 12 0.6 [.025] 3-2 4 0.08 [.003] 06027 1-192047-0									
[.013][.06] A 12 0.6 [.025] UNPL 4 0.08 [.003] 06024 1-192047-9									
[.023] -- C 12 -- 1-2 73 0.10 [.004] 06061 1-192047-8 OBSOLETE									
[.025] -- C 12 -- 1-2 23 0.10 [.004] 06078 1-192047-7									
[.014] -- C 12 -- UNPL ¹³ 0.10 [.004] 06048 1-192047-6									
[.014] -- C 12 -- UNPL ¹³ 0.10 [.004] 06012 1-192047-5									
-- -- -- -- -- -- -- -- -- -- 1-192047-4 OBSOLETE									
-- -- -- -- -- -- -- -- -- -- 1-192047-3 OBSOLETE									
SUPERSEDED BY 193709-2									
-- -- -- -- -- -- -- -- -- -- 1-192047-2 SUPERSEDED									
-- -- -- -- -- -- -- -- -- -- 1-192047-1 OBSOLETE									

C

B

A

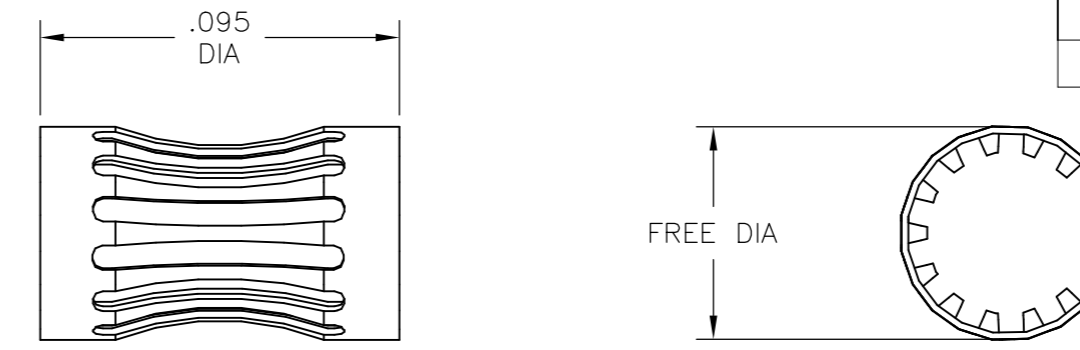

STYLE A
(FEMALE)

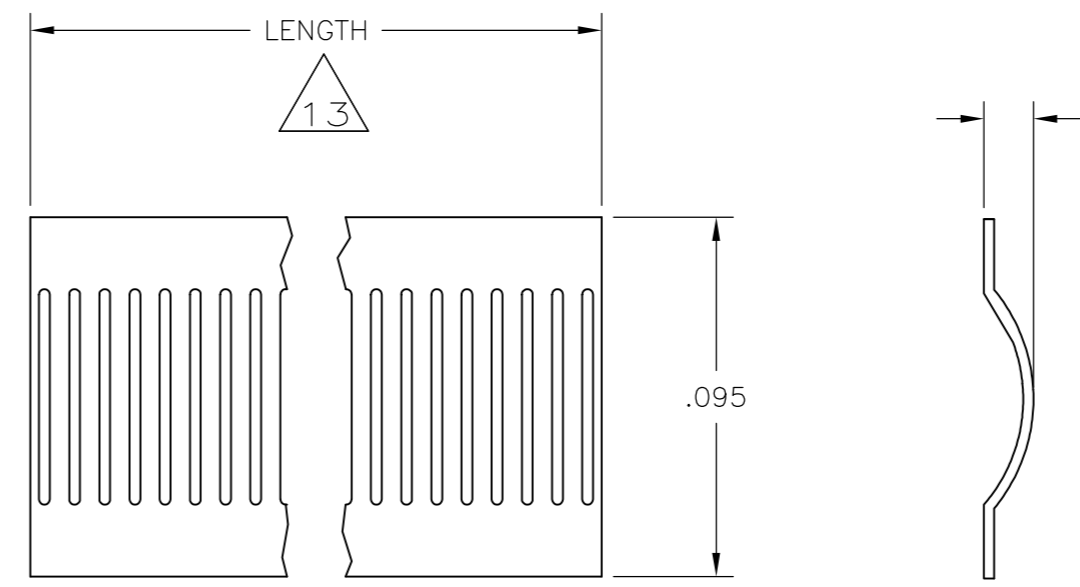

STYLE C
(STRIP)

- 1 FINISH-SILVER PLATE 200μIN THICK MIN.
 - 2 FINISH-NICKEL PLATE 40μIN THICK MIN.
 - 3 FINISH-GOLD PLATE 10μIN THICK MIN.
 - 4 FINISH-GOLD PLATE 50μIN THICK MIN.
 - 5 FINISH-TIN PLATE 300μIN THICK MIN.
 - 6 FINISH-GOLD PLATE 20μIN THICK MIN.
 - 7 FINISH-NICKEL PLATE 50μIN THICK MIN.
 - 8 NOT USED.
 - 9 NOT USED.
 - 10 NOT USED.
 - 11 PLATING NOTES ARE TO BE INTERPRETED AS FOLLOWS FOLLOWS, 3-2 AS 3 OVER 2.
 - 12 MATERIAL-CDA172, BeCu.
- ¹³ PRODUCT IS SOLD BY THE FOOT.
- ¹⁴ PRELIMINARY PART NUMBER.

LH	(FREE DIA)	STYLE	MAT'L (NOTE)	MATING PIN φ REF	PLATING (NOTE)	NUM LOUV	MAT'L THK	REF	PART NUMBER
----	------------	-------	--------------	------------------	----------------	----------	-----------	-----	-------------

THIS DRAWING IS A CONTROLLED DOCUMENT.		DWN RA JAYNE 06-11-92	TE Connectivity Ltd.	
DIMENSIONS: INCHES		CHK RA JAYNE 06-11-92		
TOLERANCES UNLESS OTHERWISE SPECIFIED:		APVD	NAME	
0 PLC ± -		PRODUCT SPEC		
1 PLC ± -		APPLICATION SPEC		
2 PLC ± 0.5		SIZE CAGE CODE DRAWING NO RESTRICTED TO		
3 PLC ± 0.25		A2 00779 C=192047		
4 PLC ± -		CUSTOMER DRAWING SCALE 20:1 SHEET 1 OF 2 REV N		
ANGLES ± -				
MATERIAL SEE TABLE				
FINISH SEE TABLE				

THIS DRAWING IS UNPUBLISHED. RELEASED FOR PUBLICATION
 © COPYRIGHT - By - ALL RIGHTS RESERVED.

REVISIONS					
P	LTR	DESCRIPTION	DATE	DWN	APVD
-	-	SEE SHEET 1	-	-	-

[.012]	[.33]	A	12	6.5[.256]	1-2	29	0.10[.004]	--	9-192047-0	OBSOLETE
[.012]	[.33]	A	12	6.5[.256]	3-2	29	0.10[.004]	--	8-192047-9	OBSOLETE
[.012]	[.13]	A	12	2.54[.100]	17-2	12	0.10[.004]	--	8-192047-8	15
[.014]	[.38]	A	12	7.9[.313]	3-2	35	0.10[.004]	--	8-192047-7	15
[.012]	[.06]	A	12	1.0[.040]	5-2	6	0.10[.004]	--	8-192047-6	15
[.023]	--	C	12	--	2	35	0.10[.004]	--	8-192047-5	15
[.023]	--	C	12	--	2	--	0.10[.004]	--	8-192047-4	15
[.012]	[.33]	A	12	6.5[.256]	6-2	29	0.10[.004]	--	8-192047-3	15
[.012]	[.57]	A	12	11.9[.471]	6-2	55	0.10[.004]	--	8-192047-2	15
[.014]	[.09]	A	12	1.57[.062]	UNPL	6	0.10[.004]	--	8-192047-1	18
[.014]	[.09]	A	12	1.57[.062]	3-2	6	0.10[.004]	--	8-192047-0	18
[.025]	--	C	12	--	UNPL	23	0.10[.004]	--	7-192047-9	OBSOLETE
[.012]	[.43]	A	12	10.1[.400]	UNPL	45	0.10[.004]	--	7-192047-8	15
[.012]	[.40]	A	12	8.7[.342]	UNPL	39	0.10[.004]	--	7-192047-7	15
[.012]	[.36]	A	12	7.2[.284]	UNPL	32	0.10[.004]	--	7-192047-6	15
[.012]	[.29]	A	12	6.5[.256]	UNPL	29	0.10[.004]	--	7-192047-5	OBSOLETE
[.012]	[.28]	A	12	6.1[.241]	UNPL	28	0.10[.004]	--	7-192047-4	15
[.012]	[.26]	A	12	5.7[.226]	UNPL	26	0.10[.004]	--	7-192047-3	15
[.012]	[.25]	A	12	5.3[.210]	UNPL	24	0.10[.004]	--	7-192047-2	15
[.012]	[.23]	A	12	4.8[.188]	UNPL	22	0.10[.004]	--	7-192047-1	15
[.012]	[.20]	A	12	4.3[.168]	UNPL	19	0.10[.004]	--	7-192047-0	15
[.023]	--	C	12	--	UNPL	--	0.10[.004]	--	6-192047-9	OBSOLETE
[.012]	[.06]	A	12	1.0[.040]	4-7	6	0.10[.004]	--	6-192047-8	18
NO DATA									6-192047-7	15
NO DATA									6-192047-6	15
NO DATA									6-192047-5	15
NO DATA									6-192047-4	15
[.012]	[.43]	A	12	1.0[.040]	4-2	45	0.10[.004]	06085	6-192047-3	15
								06800	6-192047-2	OBSOLETE 18
								06801	6-192047-1	SUPERSEDED
								06078	6-192047-0	SUPERSEDED
								06054	5-192047-9	OBSOLETE 18
								06053	5-192047-8	OBSOLETE
[.012]	[.52]	A	12	12.7[.500]	UNPL	55	0.10[.004]	06057	5-192047-7	OBSOLETE 18
[.012]	[.43]	A	12	10.1[.400]	3-2	45	0.10[.004]	06020	5-192047-6	15
[.012]	[.40]	A	12	8.7[.342]	3-2	39	0.10[.004]	06019	5-192047-5	OBSOLETE 18
[.012]	[.36]	A	12	7.2[.284]	3-2	32	0.10[.004]	06018	5-192047-4	OBSOLETE 18
[.012]	[.35]	A	12	6.9[.272]	6-2	31	0.10[.004]	06046	5-192047-3	15
[.012]	[.35]	A	12	6.9[.272]	UNPL	31	0.10[.004]	06077	5-192047-2	OBSOLETE 18
[.012]	[.33]	A	12	6.5[.256]	4-2	29	0.10[.004]	06040	5-192047-1	15
LH	(FREE DIA)	STYLE	MAT'L (NOTE)	MATING PIN ϕ REF	PLATING	NUM LOUV	MATL THK	REF	PART NUMBER	

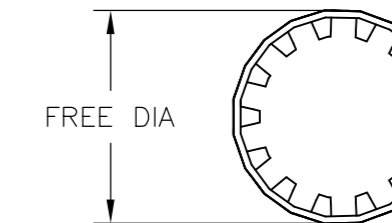
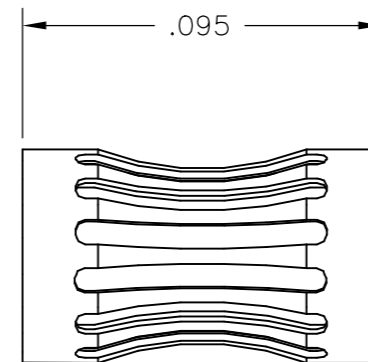

STYLE A
(FEMALE)

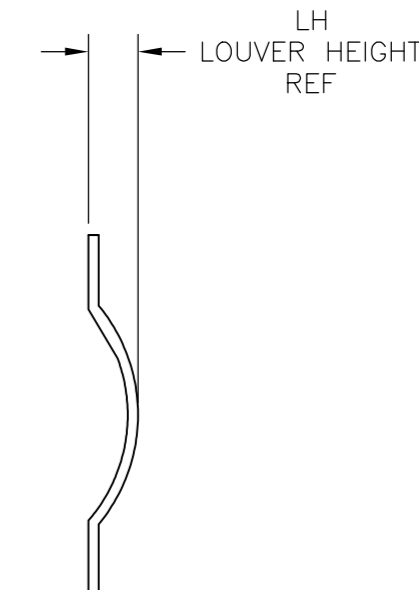
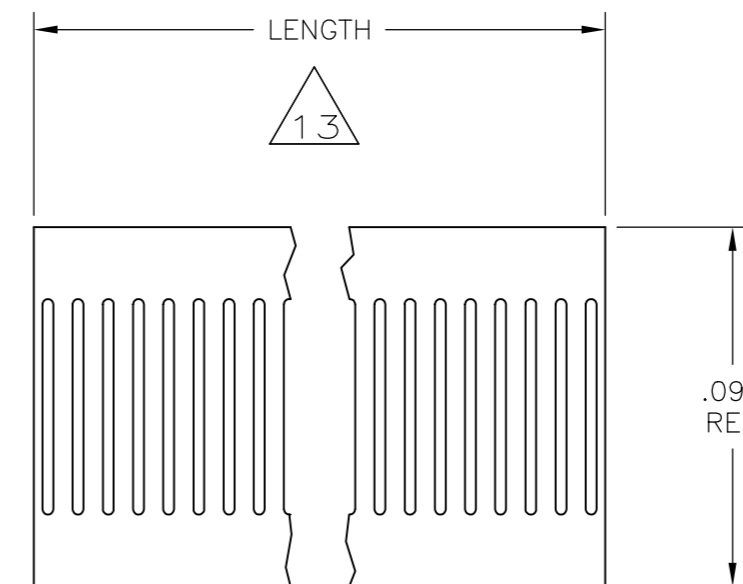

STYLE C
(STRIP)

15 CUT TO LENGTH OF 25mm.

16 OBSOLETE PART NUMBER.

17 FINISH: GOLD PLATE 30 MIN THICK MIN.

18 OBSOLETE PARTS: OBSOLETE CIS STREAMLINING PER D.RENAUD/D.SINISI

THIS DRAWING IS A CONTROLLED DOCUMENT.		DWN RA JAYNE 06-11-92	TE Connectivity Ltd.	
		CHK RA JAYNE 06-11-92		
DIMENSIONS: INCHES		APVD -	NAME CONTACT BAND,FEMALE	
TOLERANCES UNLESS OTHERWISE SPECIFIED:		PRODUCT SPEC -	APPLICATION SPEC -	
0 PLC ± - 1 PLC ± - 2 PLC ± .02 3 PLC ± .010 4 PLC ± - ANGLES ± -		WEIGHT -	SIZE A2	CAGE CODE 00779
MATERIAL SEE TABLE		FINISH SEE TABLE	DRAWING NO C=192047	RESTRICTED TO -
CUSTOMER DRAWING			SCALE 20:1	SHEET 2 of 2
			REV N	