

THIS DRAWING IS UNPUBLISHED. RELEASED FOR PUBLICATION BY TYCO ELECTRONICS CORPORATION. ALL RIGHTS RESERVED.

LOC	QST	REV PER	DATE
AJ 16	G	0514-0252-04	12-02-04
DESCRIPTION		REV PER	DATE
		0514-0252-04	12-02-04
		JDP	CM

- 1 BRASS PER QQ-B-626.
- 2 PTFE PER MIL-P-19468.
- 3 PHOSPHOR BRONZE PER QQ-B-750.
- 4 BERYLLIUM COPPER PER QQ-C-530.
- 5 TIN PLATE PER ASTM-B-545.
- 6 COPPER PLATE PER MIL-C-14550.
- 7 NICKEL PLATE PER QQ-N-290.
- 8 GOLD PLATE PER MIL-G-45204.

9. DIELECTRIC AND CONTACT ASSEMBLY WILL WITHSTAND 2.5 LB PUSHOUT FORCE DIRECTED FROM MATING END.

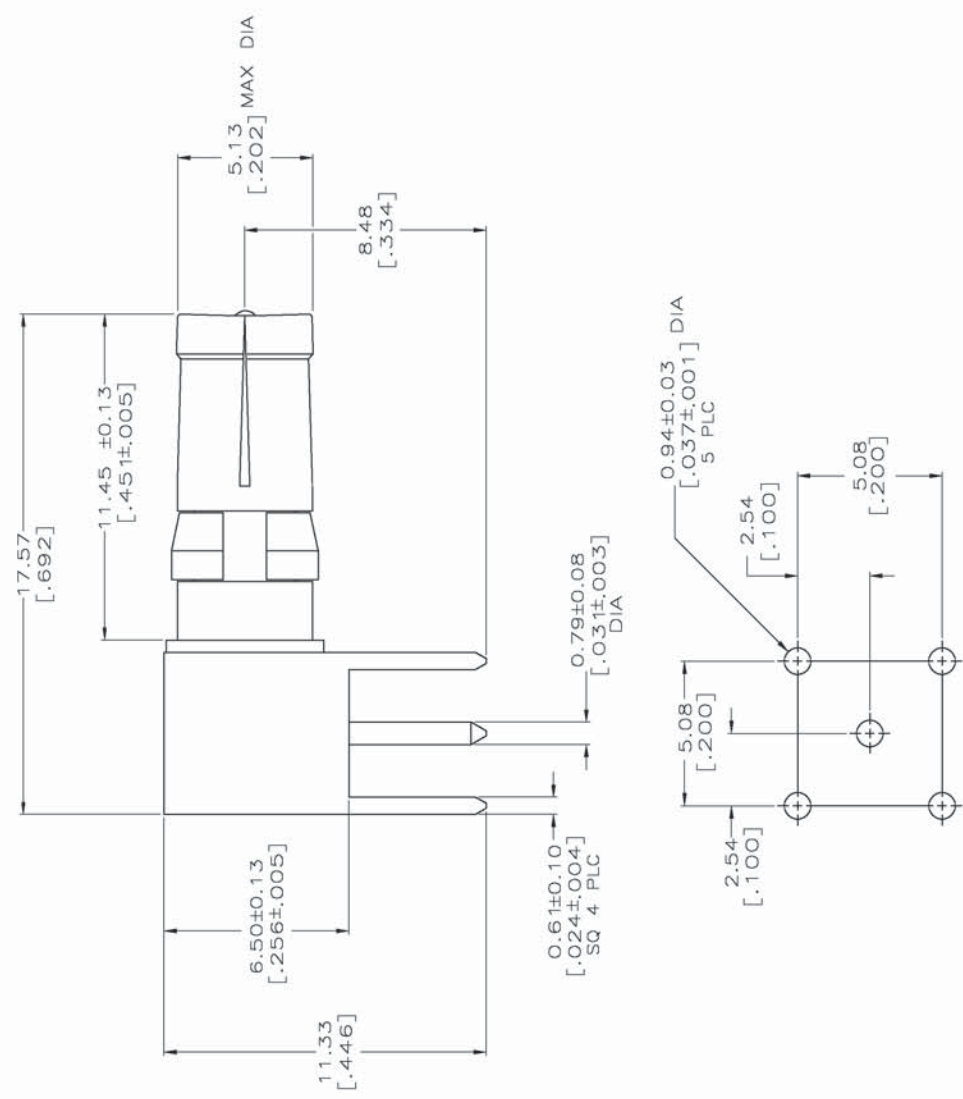

PCB CONFIGURATION

OBSOLETE	221162-2
	221162-1
PART NUMBER	

THIS DRAWING IS A CONTROLLED DOCUMENT.		REV	DATE	BY
		H. JOHNSON	09-20-91	
DRAWN BY		WERNER	09-29-91	
CHECKED BY		D. DOTE	09-3-91	
PRODUCT SPEC				
APPLICATION SPEC				
WEIGHT				
MATERIAL				
FINISH				
DIMENSIONS:				
INCHES				
DISCREPANCY:				
P. PLC				
S. PLC				
P. PLC				
S. PLC				
ANGLES				
FINISH				
SIZE		A2	00779	221162
RESTRICTED TO				
CUSTOMER DRAWING				
SCALE		1:1		
SHEET		1	OF	1
REV				

TYCO Electronics Corporation
Harrisburg, Pa. 17105-3608

SOCKET/PCB/RIGHT ANGLE
SIZE B, HDI