

PART NUMBER

SHELL	A±0.38	B±0.12	C±0.10	D±0.25	E±0.07	200 Mating cycles	500 Mating cycles
09	30.81	24.99	16.96	16.21	10.96	D09S33E4GX00**	D09S33E6GX00**
15	39.14	33.32	25.18	24.54	19.18	D15S33E4GX00**	D15S33E6GX00**
25	53.03	47.04	39.12	38.25	33.12	D25S33E4GX00**	D25S33E6GX00**
37	69.32	63.50	55.68	54.71	49.68	D37S33E4GX00**	D37S33E6GX00**

LF FOR LEAD FREE

PC card drilling dimensions(after plating)  
(thickness 1.60±0.20mm)

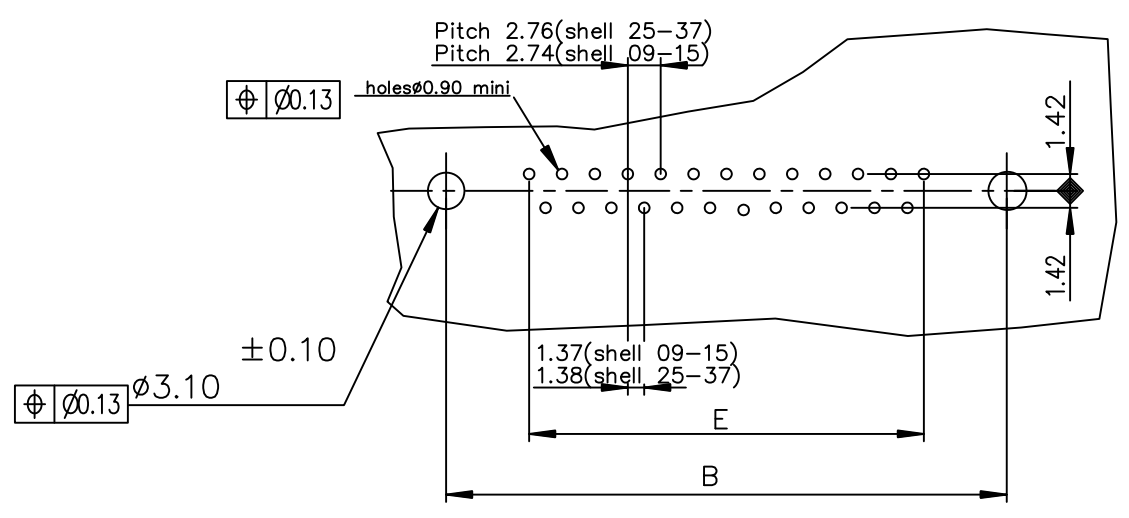

GENERAL CHARACTERISTICS : SEE DRAWING C01-8646-0000

mat'l. code		surface		tolerance		projection		product family	
-		ISO 1302 ✓		ISO 406 ISO 1101				D-SUB	
ltr		ecn no		dr		date		title	
D		ELX-I-19243		AB		2014-10-29		SOCKET CONNECT. DELTA-D R/A WITH NUT, HARPOON & METAL PLATE	
				angles		linear		scale 2:1	
				0°±2'		.0±0.1 .00±0.1 .000±0.1		MM	
				dr		JOHN SLEEBA 1994-10-14		dwg no	
				enr		ALIAS BABU 2014-10-29		sheet 1 of 1	
				chr		MITHUN PAUL 2014-10-29		size	
				app		BIJU K PAUL 2014-10-29		A3	
sheet index		revision		D				type	
1		sheet		1				Product Customer Drawing	