

THIS DRAWING IS UNPUBLISHED.

RELEASED FOR PUBLICATION

REVISIONS

© COPYRIGHT - TE Connectivity Ltd.

ALL RIGHTS RESERVED.

P	LTR	DESCRIPTION	DATE	DWN	APVD
	A	SEE SHEET 3	-	-	-

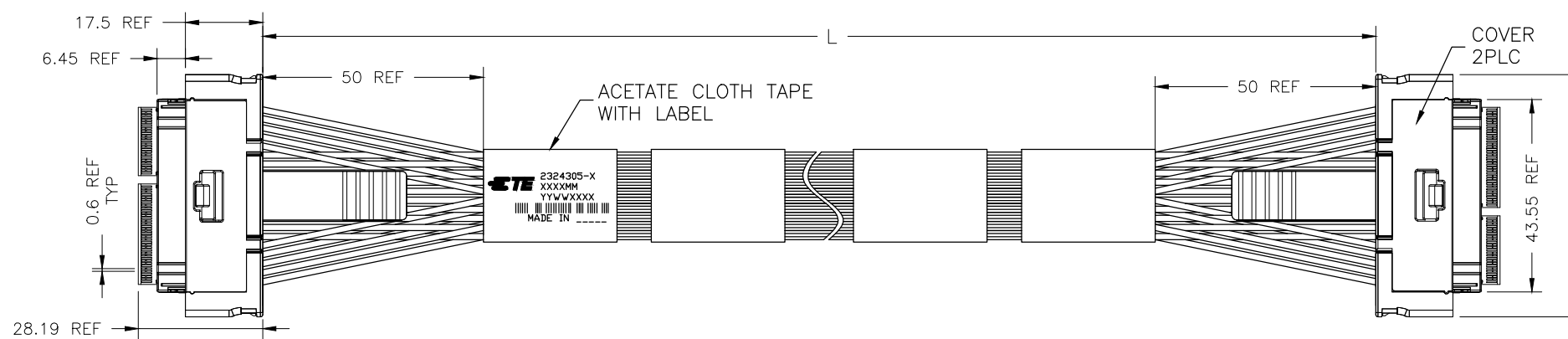
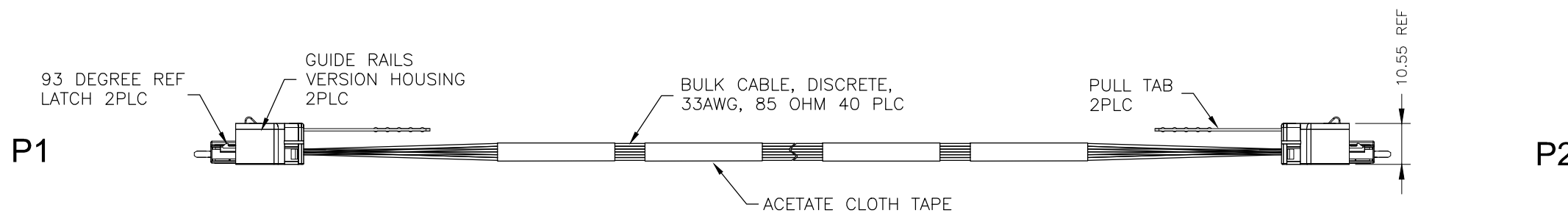
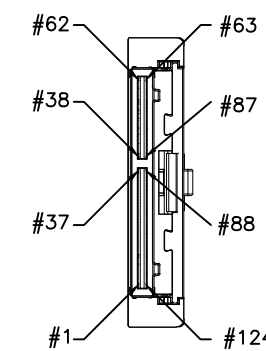
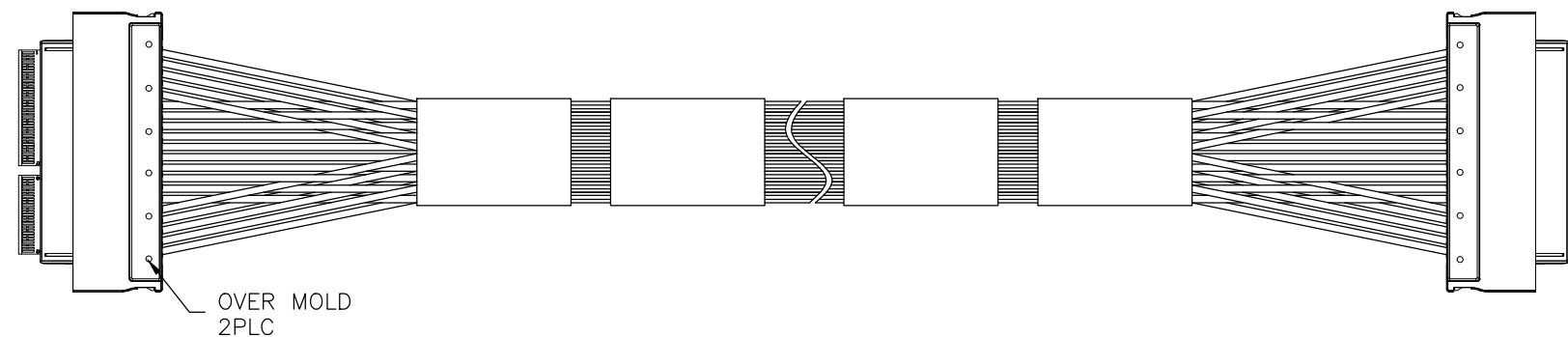
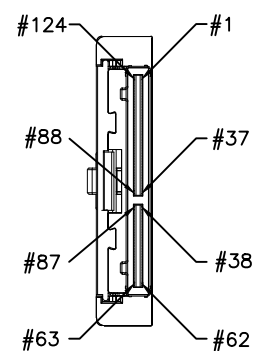

6	1000±20	2324305-2
3	500±10	2324305-1
NUMBER OF TAPE	"L" MM	TE PN

THIS DRAWING IS A CONTROLLED DOCUMENT.		DWN ANDY HOU 24AUG2018	<b>TE Connectivity</b>				
DIMENSIONS: mm		CHK ANDY HOU 24AUG2018					
TOLERANCES UNLESS OTHERWISE SPECIFIED:		APVD DAVID ZHANG 24AUG2018	NAME				
		PRODUCT SPEC	CABLE ASSEMBLY, SLIVER 124 POSITION, 85OHM, STR TO STR				
MATERIAL		FINISH	APPLICATION SPEC	SIZE	CAGE CODE	DRAWING NO	RESTRICTED TO
-		-	-	NA	A300779	C-2324305	-
CUSTOMER DRAWING			SCALE	SHEET	REV		
			1:1	1 OF 3	A		

THIS DRAWING IS UNPUBLISHED. RELEASED FOR PUBLICATION  
 © COPYRIGHT - TE Connectivity Ltd. ALL RIGHTS RESERVED.

REVISIONS					
P	LTR	DESCRIPTION	DATE	DWN	APVD
-	-	SEE SHEET 1	-	-	-

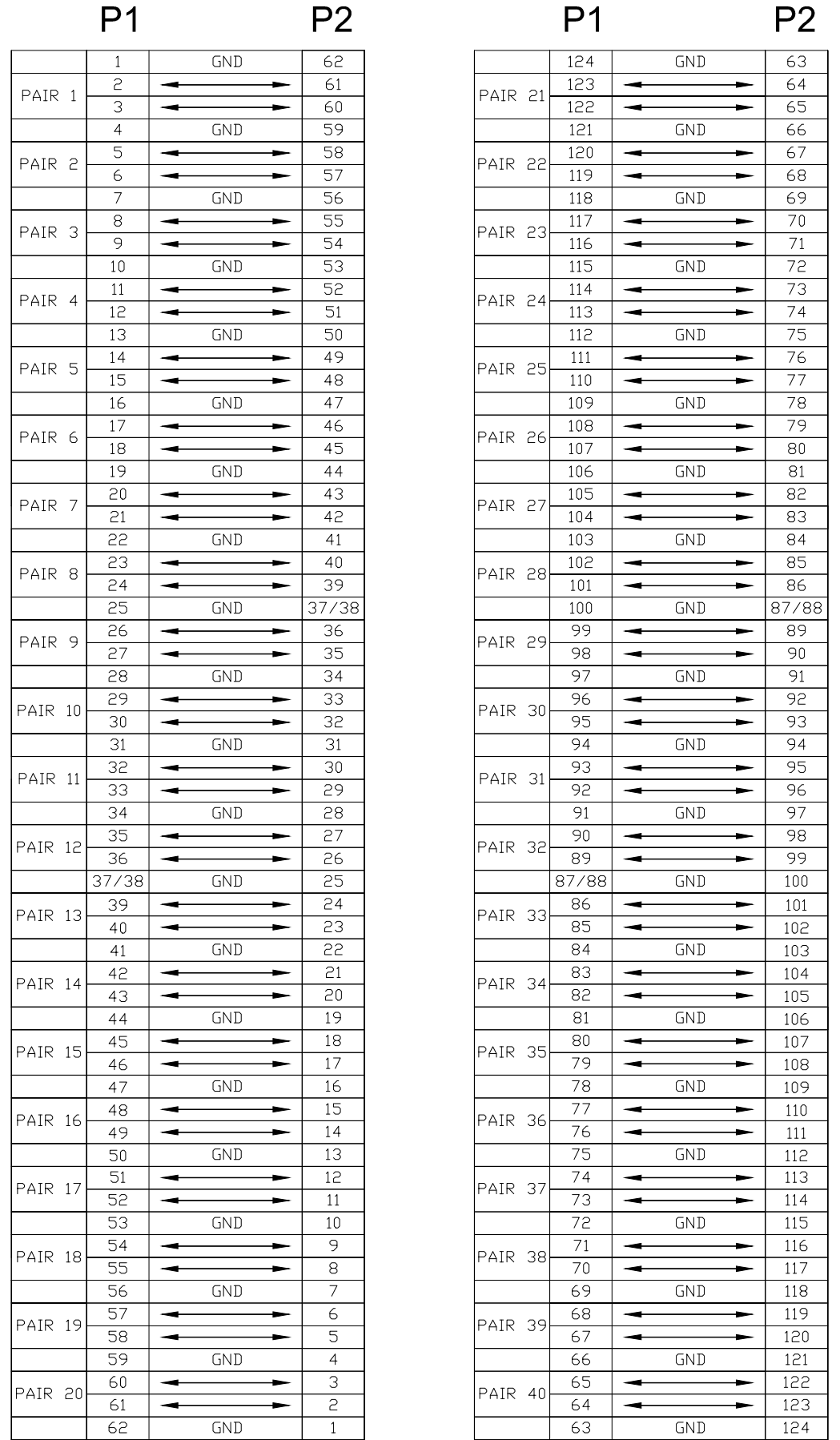

**WIRING SCHEMATIC**

- CABLE ASSEMBLY TO BE TESTED FOR OPENS, SHORTS AND WIRING MAPPING. CABLES ARE ALSO TO BE TESTED FOR SIGNAL INTEGRITY. 10% OF PRODUCT TO BE TESTED FOR SIGNAL INTEGRITY.
- All MATERIALS, COMPONENTS AND PROCESS SHALL COMPLY WITH TEC-138-702, CONTAINS NO BANNED OR RESTRICTED SUBSTANCES.
- NO REACH SvHC SHALL BE CONTAINED ABOVE THE THRESHOLD AS DEFINED IN REACH SvHC COMPLIANCE DEFINITION IN ANNEX A OF TEC-138-702.
- SEE SHEET 2 FOR WIRING SCHEMATIC.
- MINIMUM BEND RADIUS OF THE CABLE = R4.5mm IN THE CABLE THICKNESS AXIS ONLY. MIN BEND RADIUS DOES NOT APPLY TO CABLE BENT IN THE WIDTH AXIS.
- LABEL INFORMATION:

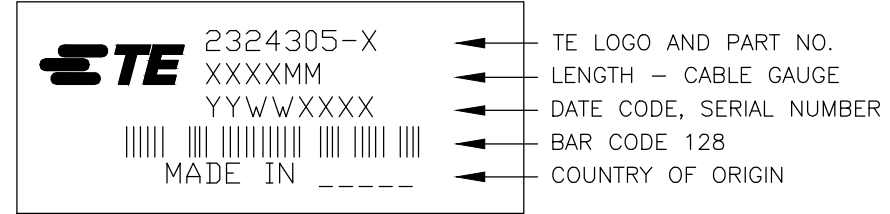

- CABLE ASSEMBLIES ARE INDIVIDUALLY PACKAGED IN A CLEAR PLASTIC TUBE, SEALED ON BOTH ENDS.

THIS DRAWING IS A CONTROLLED DOCUMENT.		DWN 24AUG2018 ANDY HOU		TE Connectivity <b>CABLE ASSEMBLY, SLIVER</b> <b>124 POSITION, 850HM, STR TO STR</b>	
DIMENSIONS: mm		CHK 24AUG2018 ANDY HOU			
TOLERANCES UNLESS OTHERWISE SPECIFIED:		APVD 24AUG2018 DAVID ZHANG		NAME	
0 PLC ± - 1 PLC ± - 2 PLC ± - 3 PLC ± - 4 PLC ± - ANGLES ± -		PRODUCT SPEC		CAGE CODE	
MATERIAL		FINISH		DRAWING NO	
-		-		A300779	
		WEIGHT NA		C=2324305	
CUSTOMER DRAWING				RESTRICTED TO	
				-	
				SCALE 1:1	
				SHEET 2 of 3	
				REV A	

THIS DRAWING IS UNPUBLISHED.

RELEASED FOR PUBLICATION

---

REVISIONS

© COPYRIGHT - TE Connectivity Ltd.

ALL RIGHTS RESERVED.

P	LTR	DESCRIPTION	DATE	DWN	APVD
-	-	SEE SHEET 1	-	-	-

2324305

STOCK DISPOSITION

REVISION HISTORY

A: CONTINUE AS IS  
D: USE OLD FIRST  
B: REWORK  
E: PARTS TO CONFORM  
C: SCRAP  
F: OTHER

DATE	REV	CHANGES	REASON	APPROVAL	INVENTORY (A,B,C,D,E,F)	WORK IN PROCESS (A,B,C,F)	SUPPLIER ORDERS (A,E,F)	OPEN CUST ORDERS (A,E,F)
24AUG2018	A	INITIAL RELEASE	INITIAL RELEASE	DZ				

THIS DRAWING IS A CONTROLLED DOCUMENT.

DWN ANDY HOU 24AUG2018

CHK ANDY HOU 24AUG2018

APVD DAVID ZHANG 24AUG2018

PRODUCT SPEC

APPLICATION SPEC

WEIGHT NA

CUSTOMER DRAWING



CABLE ASSEMBLY, SLIVER  
124 POSITION, 85OHM, STR TO STR

SIZE A3 CAGE CODE 00779 DRAWING NO C-2324305 RESTRICTED TO

SCALE 1:1 SHEET 3 of 3 REV A

DIMENSIONS:  
mm

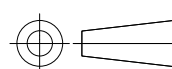

TOLERANCES UNLESS OTHERWISE SPECIFIED:

- 0 PLC ± -
- 1 PLC ± -
- 2 PLC ± -
- 3 PLC ± -
- 4 PLC ± -
- ANGLES ± -

MATERIAL -

FINISH -